

M-8500_DK

MONTAGEVEJLEDNING

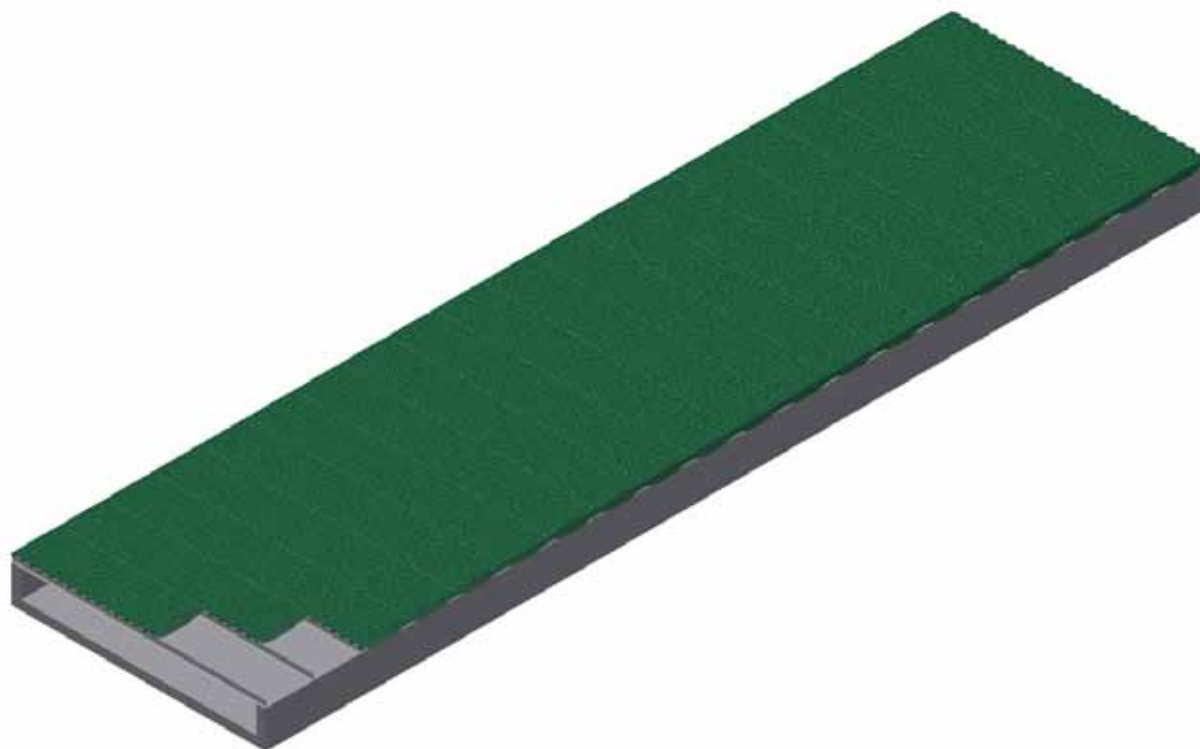

COMBI-FLOOR



ACO FUNKI A/S

Kirkevænget 5
DK-7400 Herning

Tel. +45 9711 9600

Fax +45 9711 9677

www.acofunki.com

FUNKI

DANISH DESIGN | GERMAN QUALITY | GLOBAL EXPERIENCE

MONTAGE AF BÆRING TIL COMBI-GULV

>>> OBS <<< Rum, riste og bæring skal klimatiseres til 15-18 ° inden det monteres.

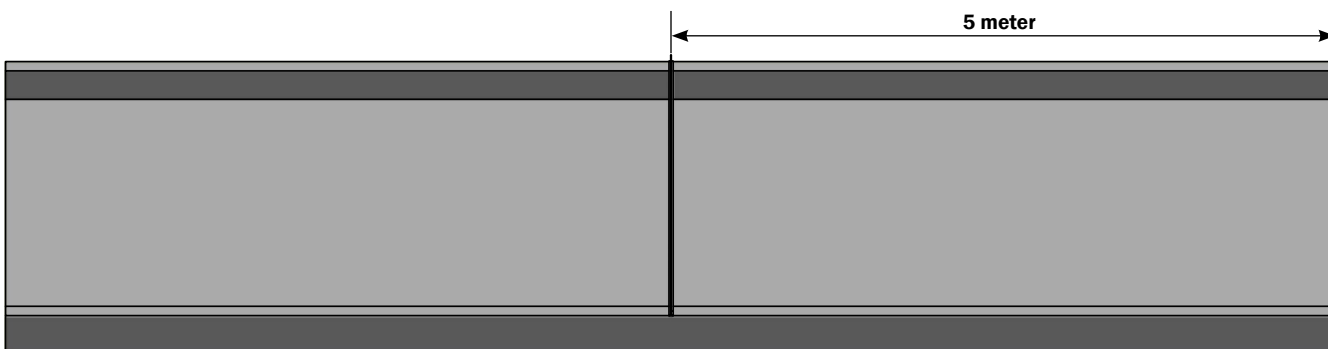
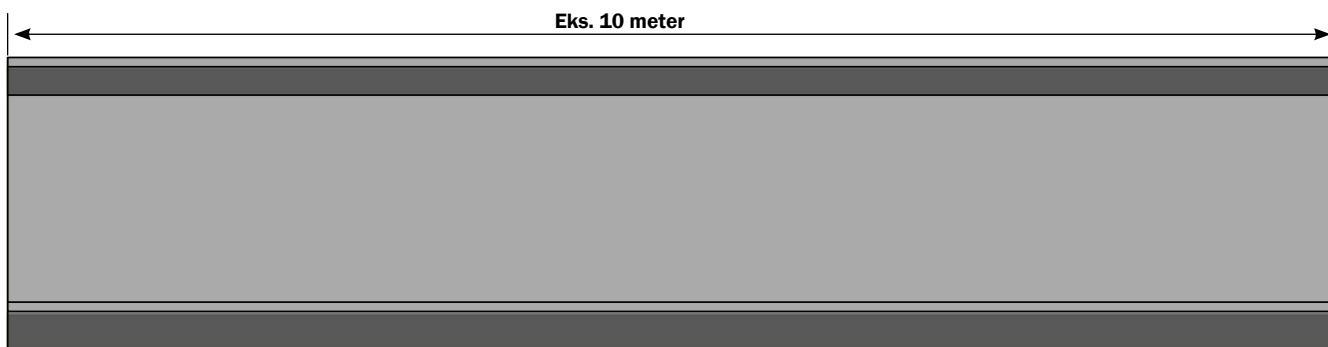

Første bæring sættes på midten af gyllekummen

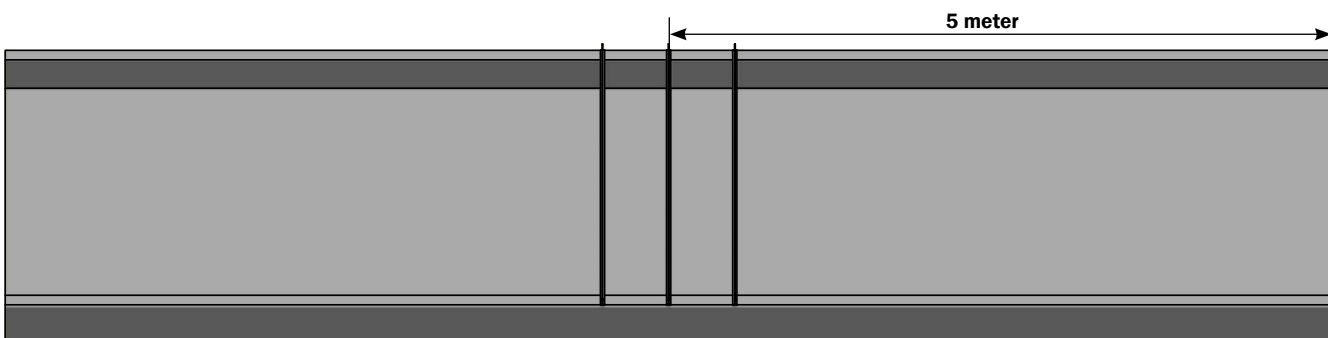

Derefter placeres der en bæring på hver side af den første bæring.

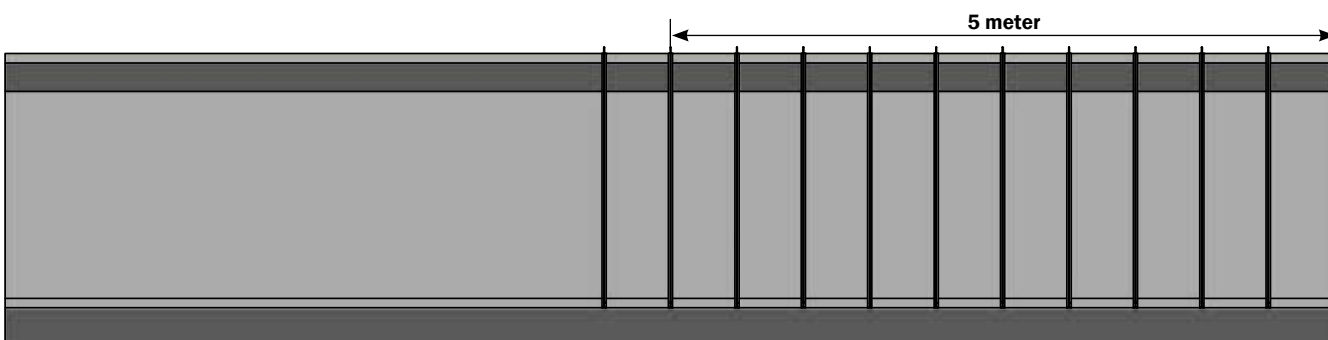

Til sidst placeres de sidste bæring på den ene side.

MONTAGE AF RISTE TIL COMBI-GULV

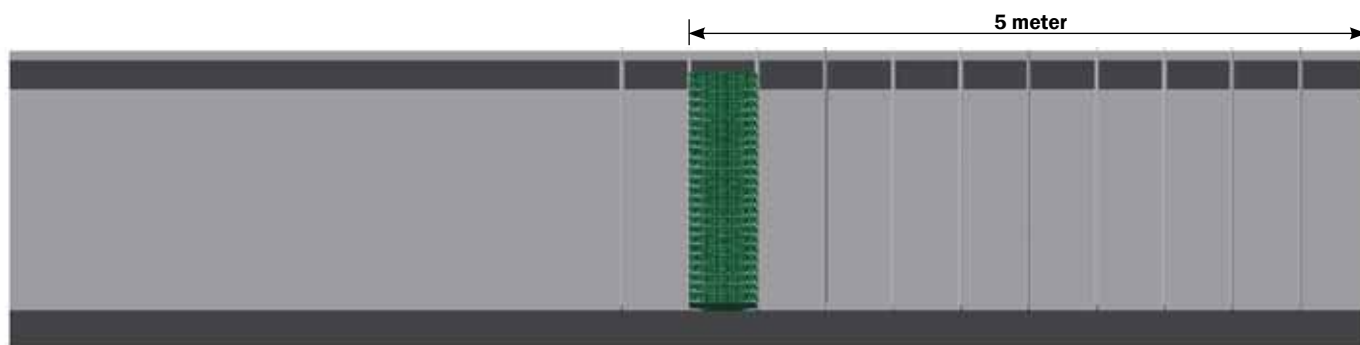

Første rist ligges mellem midtbæring og bæringen efter.

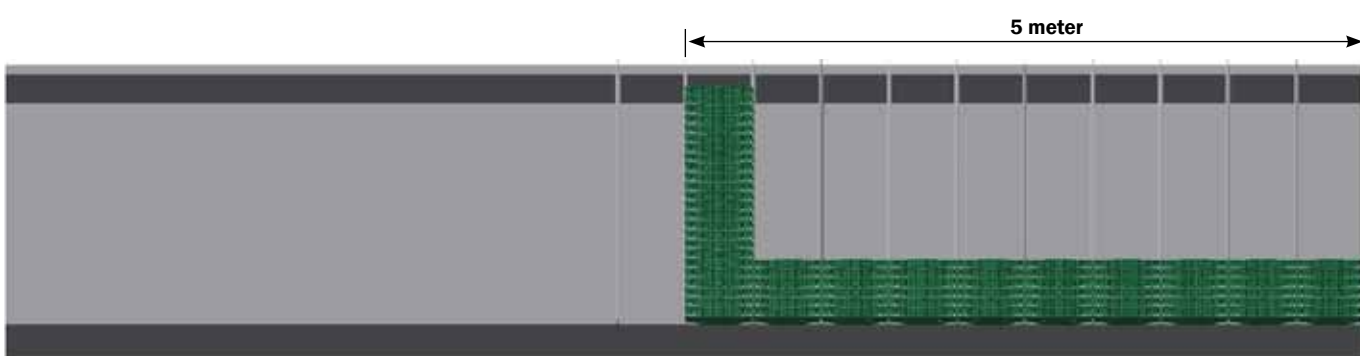

Ristene ligges i forlængelse af hinanden sidevejs

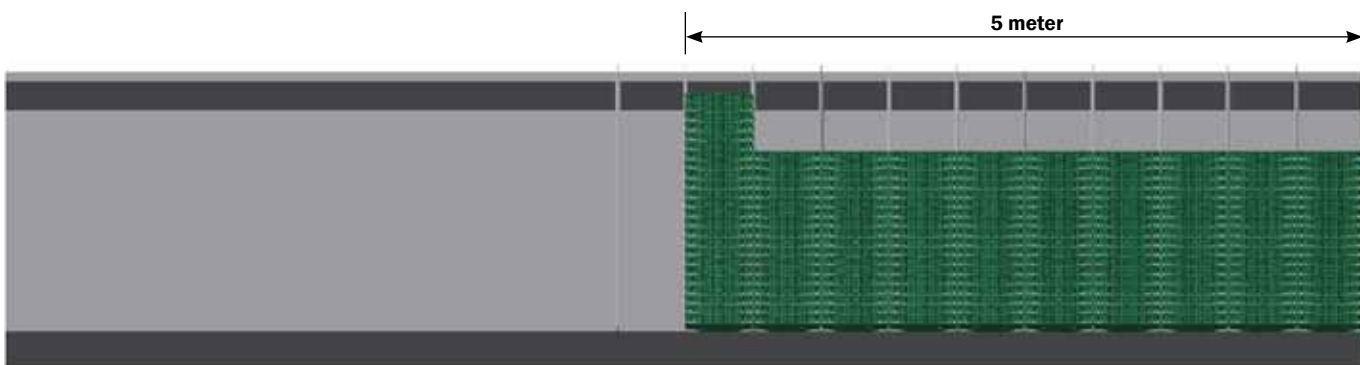
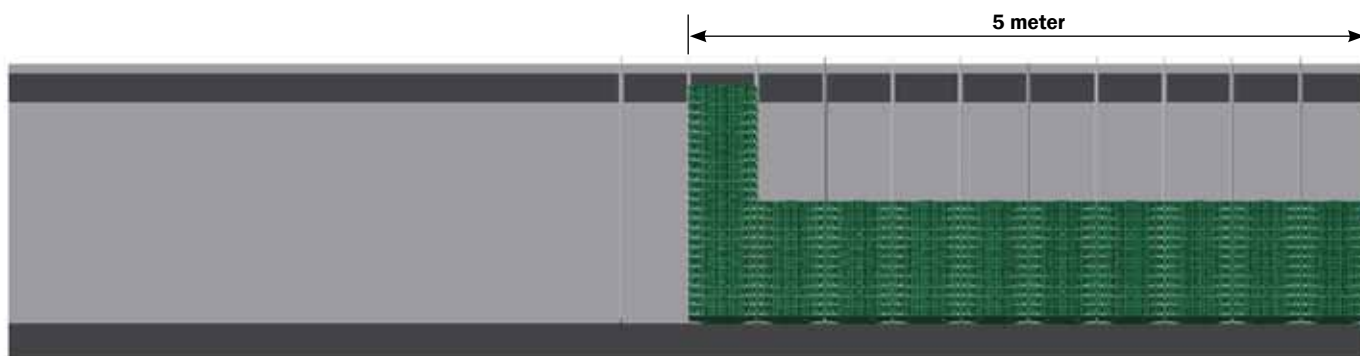

MONTAGE AF RISTE TIL COMBI-GULV

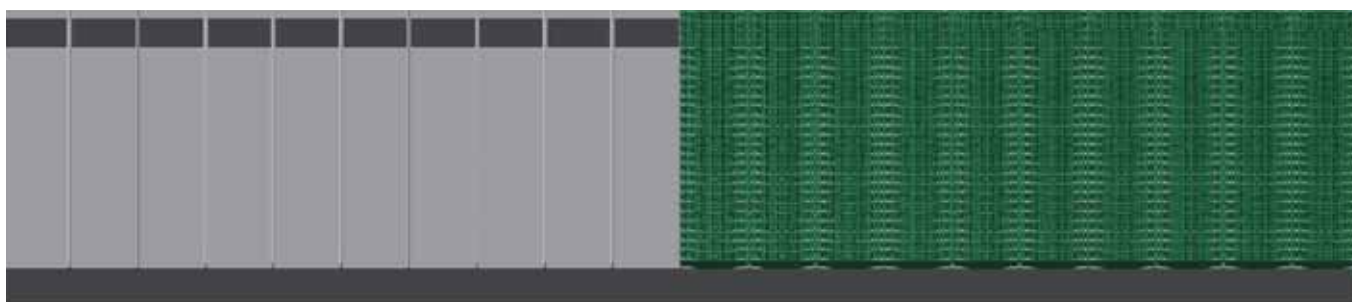

Placering af bæring side 2

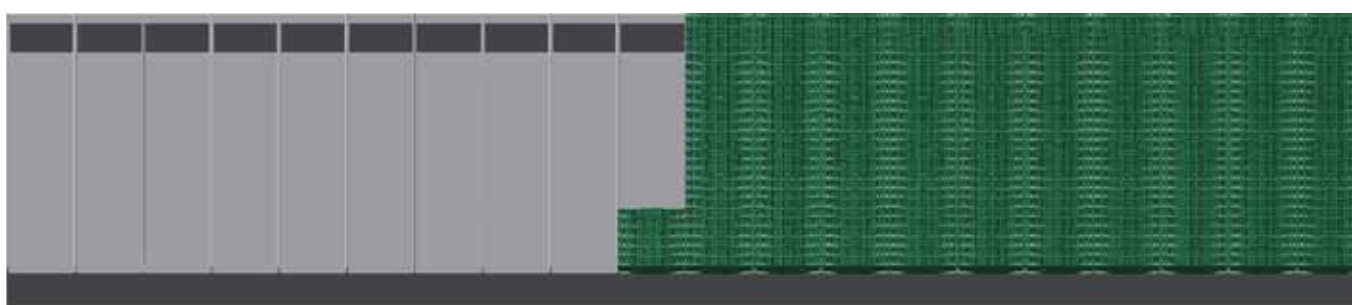

Ristene ligges i forlængelse af hinanden sidevejs

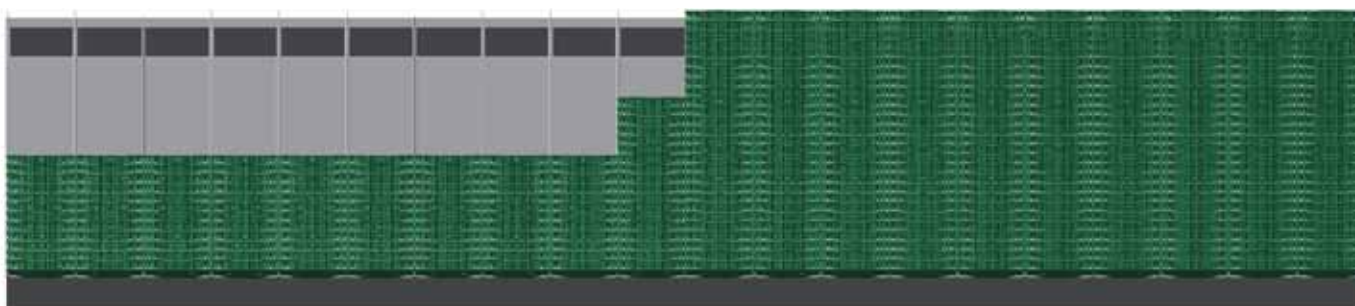
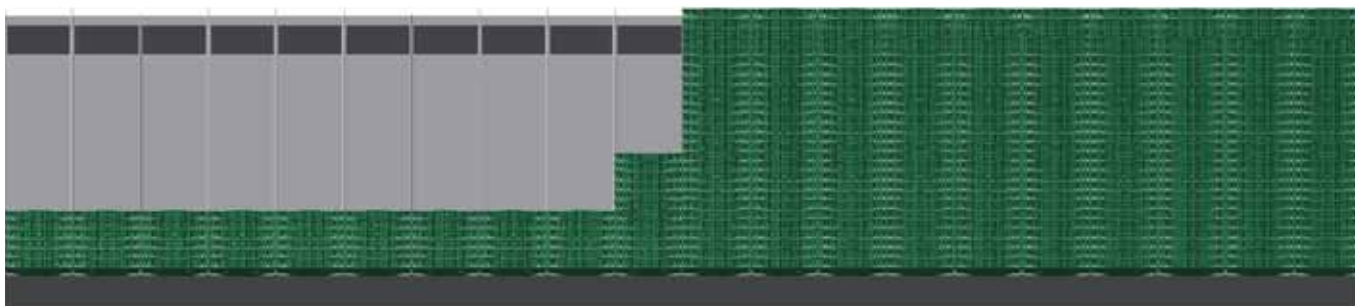

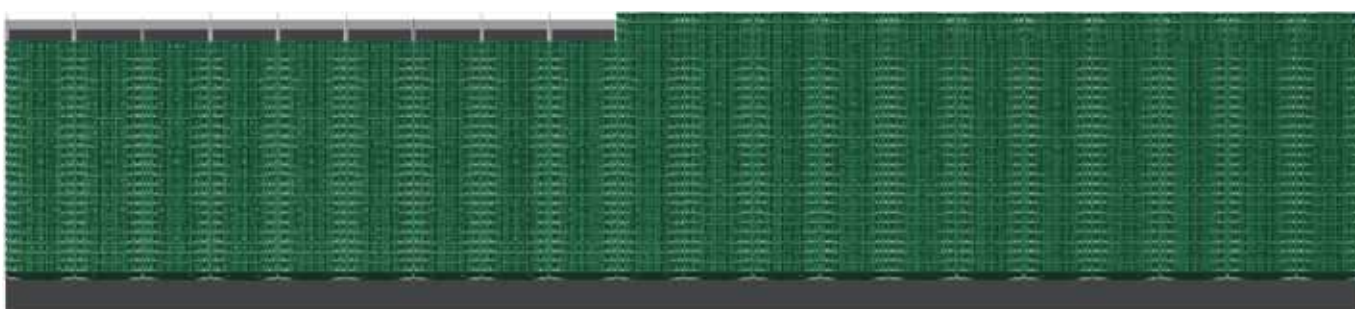
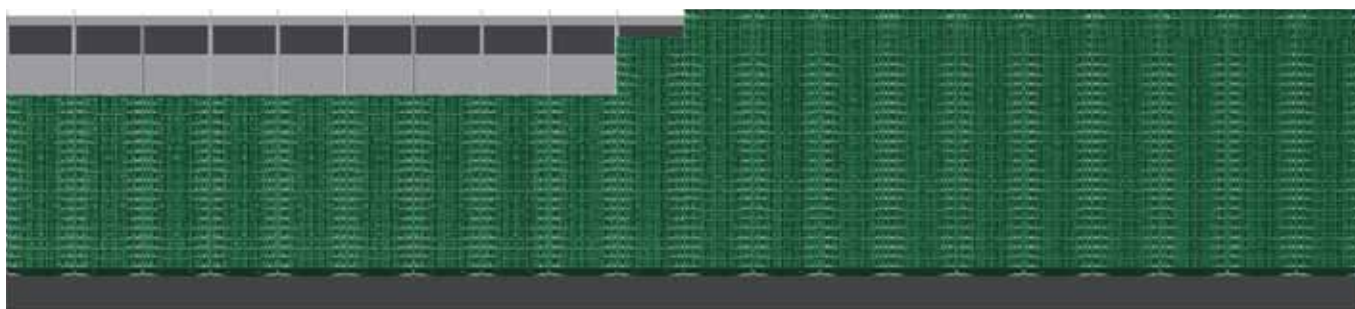

TILPASNING AF RISTE

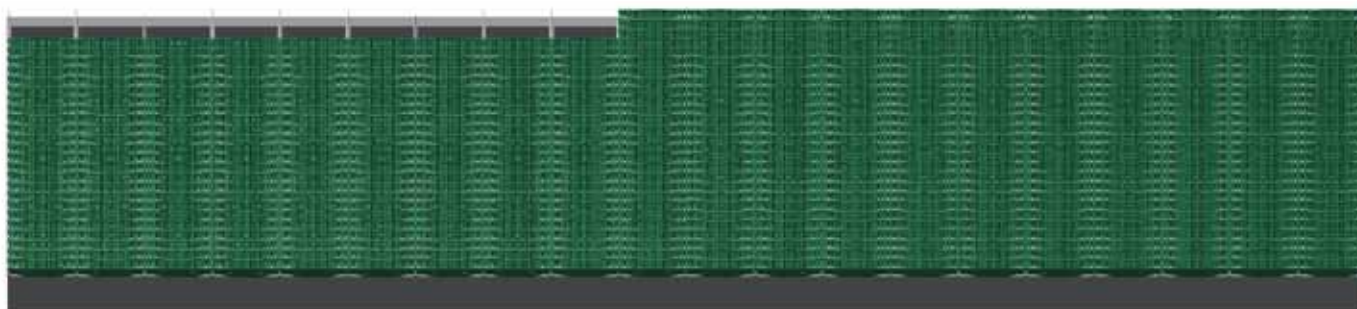
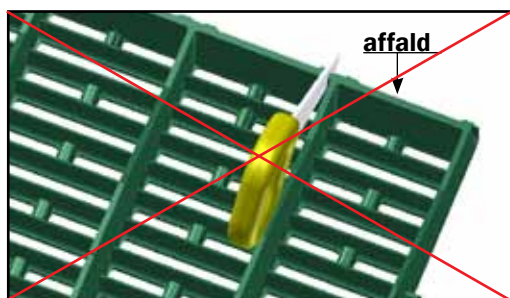

For tilpasning af riste i længderetningen

